

Wire Wound Ceramic Chip Inductors

CT Series

Lead-free / Open Type Wire Wound Chip Inductors



Due to technical expertise of accurately winding skill, these chip inductors are designed as filtering, impedance matching, resonance and choke circuits for RF designer. The stand series as well as customer design to meet your needs of telecom & wireless products.

PRODUCT IDENTIFICATION

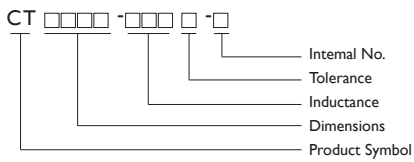

Tolerance :G=±2%, J=±5%, K=±10%

APPLICATIONS

RF products for cellular phone, GPS receiver, Base Station, Repeater, Wireless LAN/ Mouse/ Keyboard/ earphone, remote control, security system and other RF modules.

FEATURES

- Meet SONY SS-00259's criteria for lead-free product.
- Ceramic body and wire wound construction provide highest SRFs.
- These ultra-compact inductors provided exceptional Q values, even at high frequencies.
- Their ceramic construction delivers the highest possible SRFs as well as excellent Q values.
- The non-magnetic coil form also assures the utmost in thermal stability, predictability and batch consistency.
- At just 1.02mm high, CT0805 is the lowest profile SMD inductor among 0805 series.

SHAPES AND DIMENSIONS

Dimensions : mm

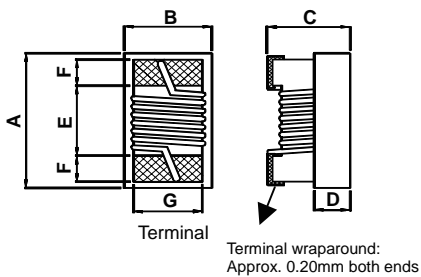

TYPE	A	B	C	D	E	F	G
CT0805	2.35 ⁺⁰	1.73 ⁺⁰	1.02 ⁺⁰	0.35Ref	1.02	0.44	1.27

RECOMMENDED PATTERN

Dimensions : mm

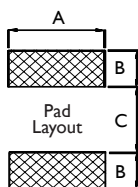

TYPE	A	B	C
CT0805	1.78	1.02	0.76



ELECTRICAL CHARACTERISTICS : LEAD-FREE & ROHS COMPLIANCE

PART NO.	Inductance	Test Frequency	Tolerance	Q	Test Frequency	SRF Min	RDC MAX	Irms Max	Color
	(nH)	(MHz)	(±%)	Min	(MHz)	(MHz)	(Ω)	(mA)	
CT0805-1N8 □ -N	1.8	250	10	55	1500	9400	0.03	800	Black
CT0805-3N9 □ -N	3.9	250	10	50	1000	6100	0.06	800	Brown
CT0805-4N7 □ -N	4.7	250	10/5	50	1000	5500	0.06	800	Red
CT0805-6N8 □ -N	6.8	250	10/5	50	1000	5500	0.08	800	Orange
CT0805-8N2 □ -N	8.2	250	10/5	50	1000	4800	0.08	800	Yellow
CT0805-10N □ -N	10	250	10/5/2	55	750	3300	0.08	800	Green
CT0805-12N □ -N	12	250	10/5/2	55	750	3800	0.10	800	Blue
CT0805-15N □ -N	15	250	10/5/2	50	500	2950	0.10	800	Violet
CT0805-18N □ -N	18	250	10/5/2	50	500	3100	0.13	800	Gray
CT0805-22N □ -N	22	250	10/5/2	50	500	2900	0.15	800	White
CT0805-27N □ -N	27	250	10/5/2	50	500	2450	0.23	600	Black
CT0805-33N □ -N	33	250	10/5/2	55	500	2350	0.28	600	Brown
CT0805-39N □ -N	39	250	10/5/2	55	500	2200	0.33	600	Red
CT0805-47N □ -N	47	200	10/5/2	50	500	2000	0.39	600	Orange
CT0805-56N □ -N	56	200	10/5/2	50	500	1850	0.39	500	Yellow
CT0805-68N □ -N	68	200	10/5/2	50	500	1500	0.40	500	Green
CT0805-82N □ -N	82	150	10/5/2	50	500	1500	0.44	500	Blue
CT0805-R10 □ -N	100	150	10/5/2	50	500	1200	0.64	400	Violet
CT0805-R12 □ -N	120	150	10/5/2	40	250	1150	0.68	300	Gray
CT0805-R15 □ -N	150	150	10/5/2	40	250	1050	0.80	300	White
CT0805-R18 □ -N	180	150	10/5/2	40	250	950	0.90	300	Black
CT0805-R22 □ -N	220	150	10/5/2	40	250	900	0.98	300	Brown
CT0805-R27 □ -N	270	150	10/5/2	40	250	850	1.30	300	Red
CT0805-R33 □ -N	330	100	10/5/2	40	250	800	1.45	300	Orange
CT0805-R39 □ -N	390	100	10/5/2	35	250	700	1.60	300	Yellow
CT0805-R47 □ -N	470	50	10/5/2	25	100	600	1.80	300	Green
CT0805-R56 □ -N	560	25	10/5/2	18	50	550	1.90	300	Blue
CT0805-R62 □ -N	620	25	10/5/2	18	50	450	2.00	300	Violet
CT0805-R68 □ -N	680	25	10/5/2	18	50	420	2.10	300	Gray
CT0805-R75 □ -N	750	25	10/5/2	18	50	400	2.20	300	White
CT0805-R82 □ -N	820	25	10/5/2	18	50	400	2.50	300	Black
CT0805-1R0 □ -N	1000	25	10/5	17	50	330	3.10	300	Brown

- When ordering, please specify tolerance and packaging code. Ex :CT0805-1R0J-N
- Tolerance : G =±2% , J =±5% , K =±10%
- Packaging : Clear Tape and Reel (Standard)
- L/Q : Agilent / HP4291A+Agilent / HP16193A
- SRF : Agilent/HP8753D / Agilent/HP4291A
- RDC : CH502BC HP4338B
- Irms for a 15°C rise above 25°C ambient
- Operating Temperature Range from -40°C to 125°C

TEST INSTRUMENTS : HP4291A MATERIAL / IMPEDANCE ANALYZER

Typical L vs Frequency

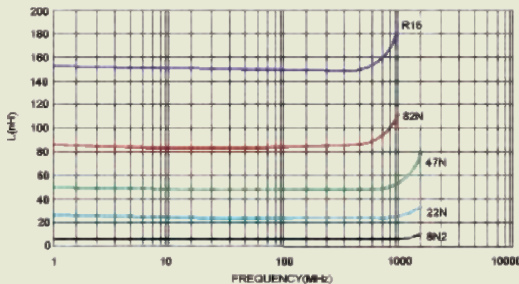

Typical Q vs Frequency

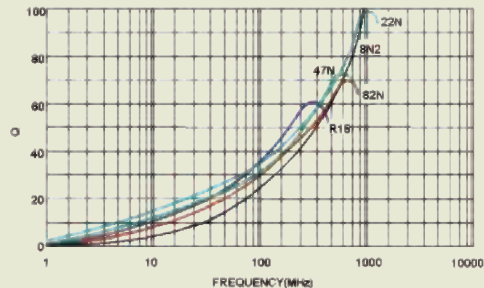



PACKAGING SPECIFICATIONS

Tape Dimensions

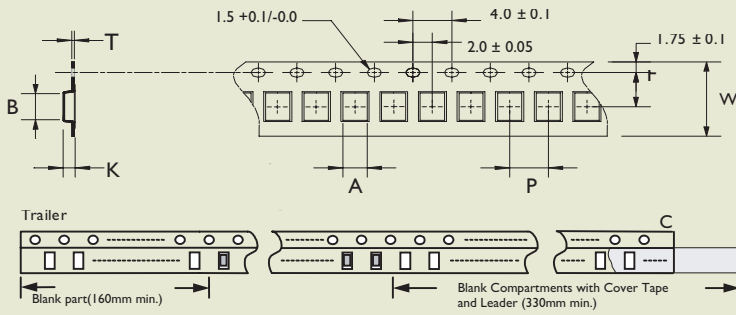

Reel Dimensions

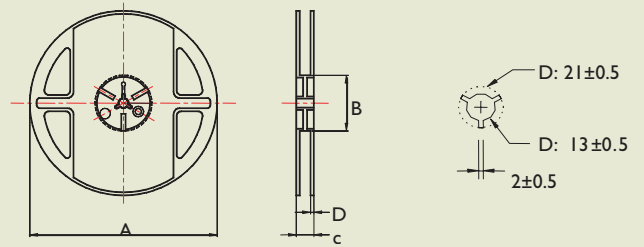

Dimensions : mm

TYPE	TAPE DIMENSIONS							REEL DIMENSIONS				QUANTITY/REEL
	A	B	T	W	P	F	K	A	B	C	D	
CT0805	1.85	2.45	0.23	8	4	3.5	1.00	178	60	12	1.5	2000

RECOMMEND SOLDERING CONDITIONS

for:CS/ CT/ LCN/ HC/ HQ/ CMM/ NL (open type)/ NLC (open type)/ LS

